

# Welcome to Old Faithful Lodge

The Management and Staff wish you an enjoyable visit.

Please note that many roads in the Old Faithful Area are one-way only, see directional arrows on this map.

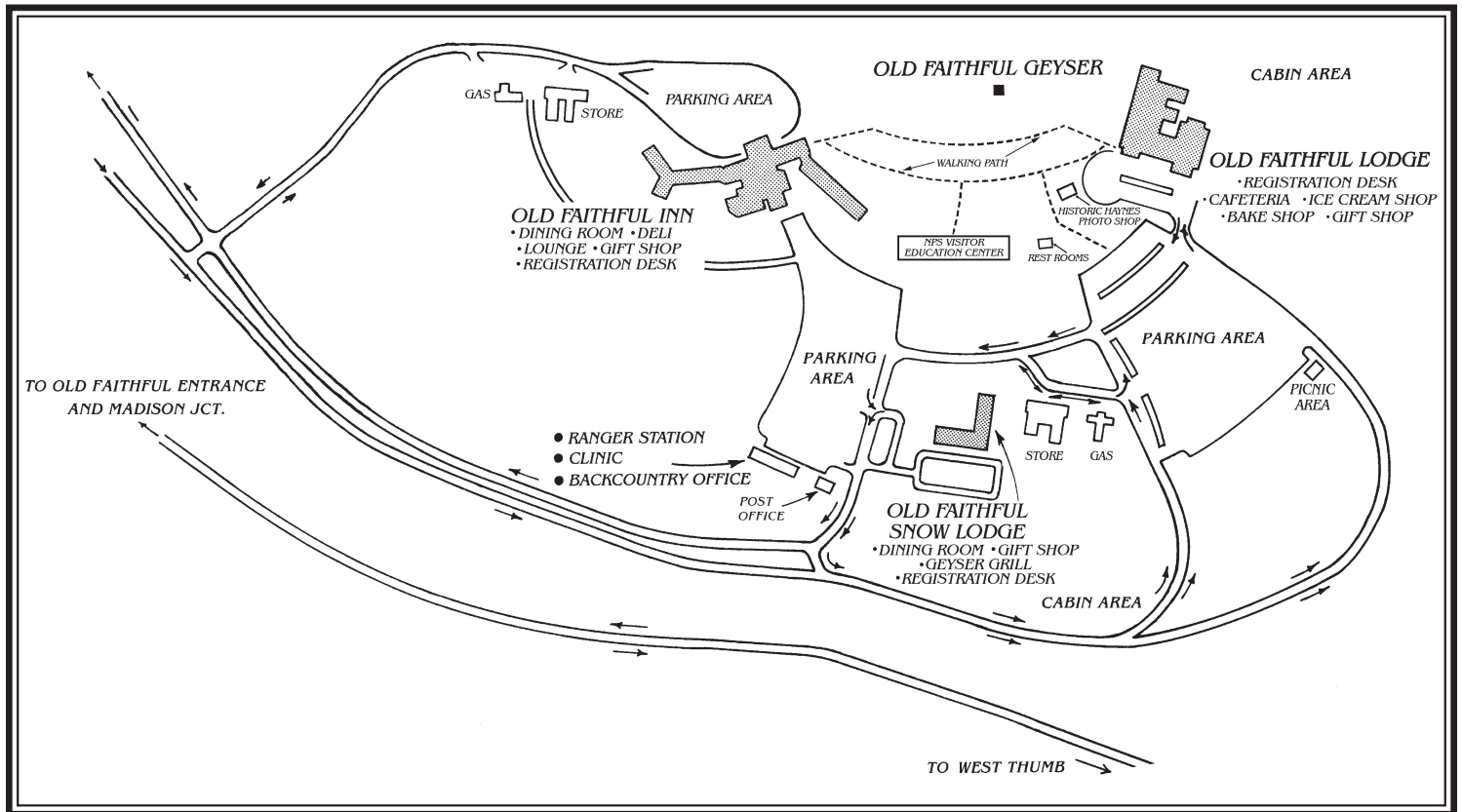

- Old Faithful Inn Dining Room requires reservations for dinner. Please call the dining room directly by dialing ext. 4999 from your guest room phone or you may stop by the Front Desk.
- To dial directly to another room, please refer to the Guest Service Directory for a list of room phone extensions.
- Housekeeping starts working at 8 am. Please place your "Do Not Disturb" sign on your door if you do not wish to be disturbed.

## YELLOWSTONE

NATIONAL PARK LODGES

*Legendary Hospitality by Xanterra*

Authorized Concessioner of the  
National Park Service  
offers the following activities...

### Picture Perfect Photo Safari

Explore the thermal features and scenic areas from the Firehole to the Madison with a photographer-guide who knows the photo hot spots and prime times.

### Geyser Gazers

Join us for a 1½-hour adventure in the *Fire Hole*, a name bestowed by mountain men of the early 19th century.

### Twilight on the Firehole

Exploring the Firehole area during the later part of the day is especially appealing as the later daylight adds a dramatic hue to the landscape.

### Circle of Fire Tour

Discover the story and scenery behind Yellowstone's amazing geysers and hot springs!

### Yellowstone in a Day

A great overview of the park! Recommended as a "best first activity" by many of our guests. We'll show you the park highlights, including Yellowstone Lake, the Grand Canyon of the Yellowstone and Mammoth Hot Springs.

### Firehole Basin Adventure

This three-hour exploration will take you to where the action is "steamulating." Your guide will help you leave with a new appreciation and understanding of Yellowstone's underground plumbing.

Stop by any of our Activity Desks or Front Desks for more information, reservations, and to pick up one of our Experience Planners

# OLD FAITHFUL LODGE

## CABIN MAP

CHECK-OUT TIME  
11:00 A.M.

\*Please Return  
Key to Front Desk\*  
----- WALKING PATH  
♿ ACCESSIBLE PARKING

CABIN NUMBER:

LOWER  
LOOP  
CABINS

UPPER  
LOOP  
CABINS

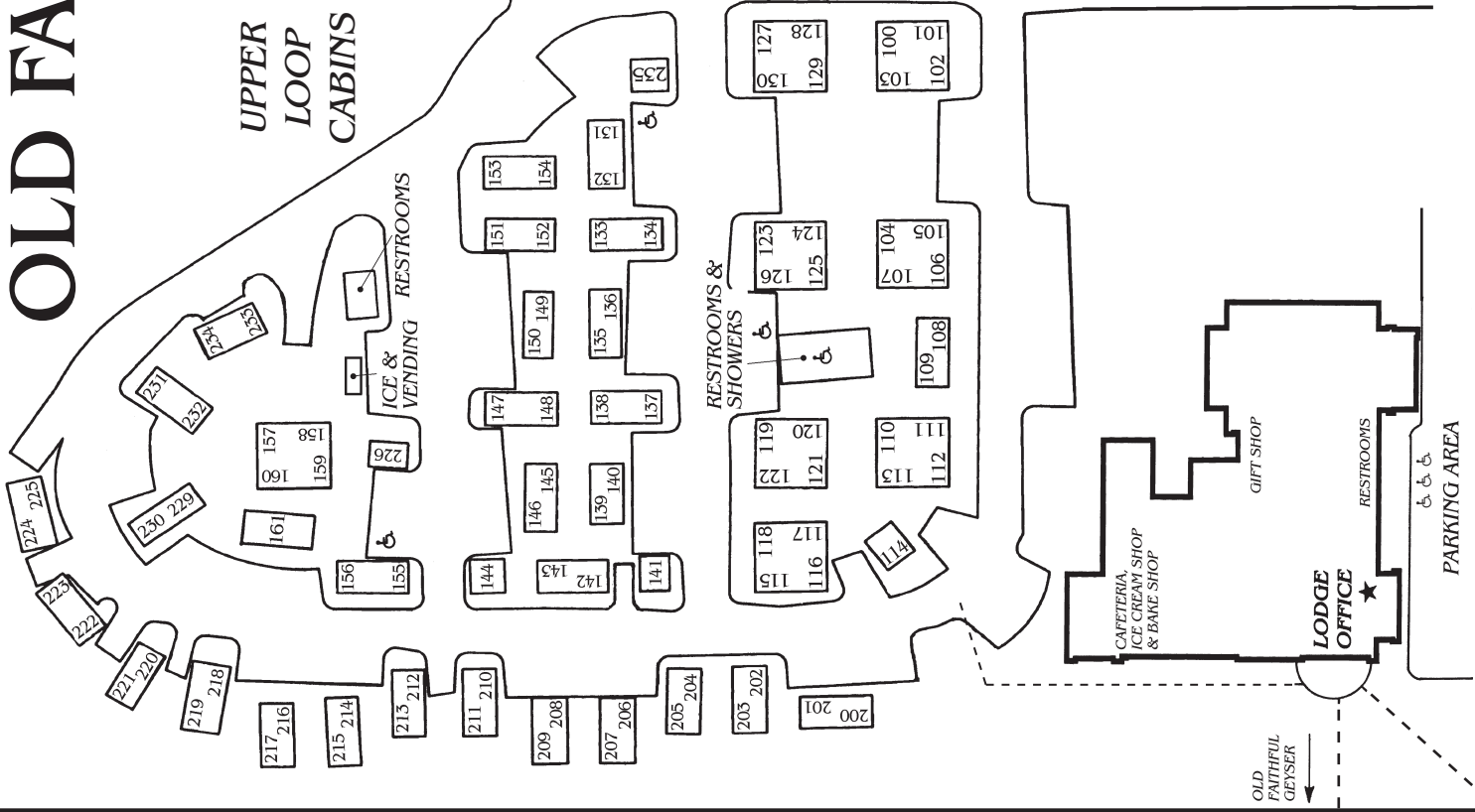

OLD  
FAITHFUL  
GEYSER

LODGE  
OFFICE

GIFT SHOP

CAFFETERIA,  
ICE CREAM SHOP  
& B&M SHOP

PARKING AREA

RESTROOMS &  
SHOWERS

RESTROOMS &  
SHOWERS  
VENDING

